

AIR COOLED, TWO STAGE MODELS E-50 & E-71

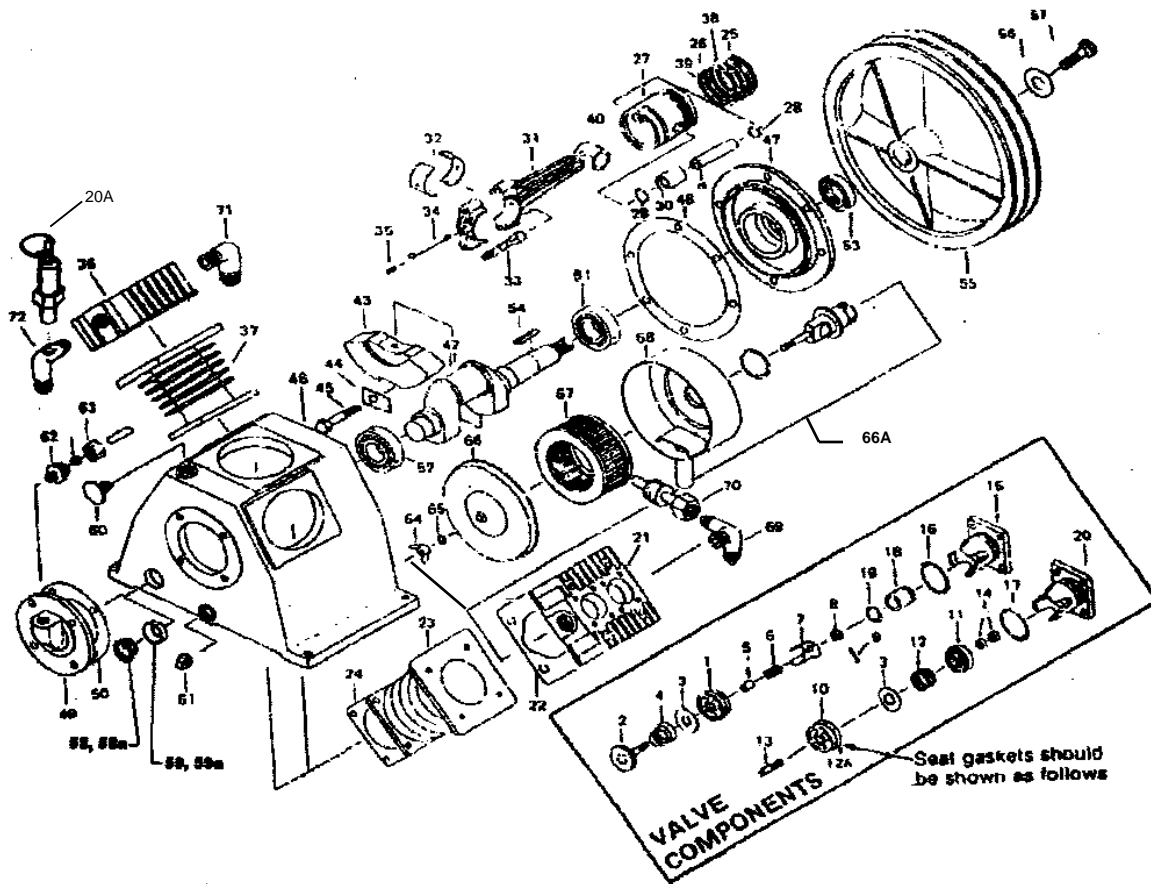

VALVE ASSEMBLIES	DESCRIPTIONS	Qty. Req.	MODEL E50		Qty. Req.	MODEL E71	
			MODEL E50	Qty. Req.		MODEL E71	Qty. Req.
	Inlet Valve Assembly, 1 st Stage	2	70123-31000	2	70124-31000		
	Inlet Valve Assembly, 2 nd Stage	1	70173-32000	1	70173-32000		
	Outlet Valve Assembly, 1 st Stage	2	70123-41000	2	70124-41000		
	Outlet Valve Assembly, 2 nd Stage	1	70123-41000	1	70123-41000		
	Breather Assembly	1	70103-57600-4024	1	70124-57600-4010		

MAIN PARTS LISTING FOR TWO STAGE MODELS E-50 & E-71

DESCRIPTIONS	MODEL E50				MODEL E71			
	Qty Req'd	1 st Stage	Qty Req'd	2 nd Stage	Qty Req'd	1 st Stage	Qty Req'd	2 nd Stage
1. Inlet Valve Seat	2	70123-31010	1	70123-31010	2	70124-31010	1	70123-31010
2. Inlet Valve Receiver	2	70123-31020	1	70123-31020	2	70124-31020	1	70123-31020
3. Inlet & Outlet Valve Plate	4	70123-31030	2	70123-31030	4	70124-31030	2	70123-31030
4. Inlet Valve Spring	2	70123-31070	1	70123-31070	2	70124-31070	1	70123-31070
5. Inlet Valve Unloading Fork Guide	2	70123-31090	1	70123-31090	2	70124-31090	1	70123-31090
6. Unloading Spring	2	70123-11230	1	70123-11230	2	70124-11230	1	70123-11230
7. Inlet Valve Unloading Fork	2	70123-31080	1	70123-31080	2	70124-31080	1	70123-31080
8. Slotted Nut	2	92502-230800	1	92502-230800	2	92502-230800	1	92502-230800
9. Cotter Pin	2	93701-130220	1	93701-130220	2	93701-130220	1	93701-130220
10. Outlet Valve Seat	2	70123-41011	1	70123-41011	2	70124-41011	1	70123-41011
11. Outlet Valve Receiver	2	70123-41020	1	70123-41020	2	70124-41020	1	70123-41020
12A. Seat Gaskets	4	70123-11110	2	70123-11110	4	70124-11110	2	70123-11110

MAIN PARTS LISTING FOR TWO STAGE MODELS E-50 & E-71 (CONTINUED)

			MODEL E-50				MODEL E-71			
DESCRIPTION			QTY	1 st Stage	QTY	2 nd Stage	QTY	1 st Stage	QTY	2 nd Stage
Valves & Unloaders	12B	Outlet Valve Spring	2	70123-41070	1	70123-41070	2	70124-41070	1	70123-41070
	13	Outlet Valve Bolt	2	70123-41810	1	70123-41810	2	70124-41810	1	70123-41810
	14	Nut (Outlet Valve)	2	92502-230800	1	92502-230800	2	92502-230800	1	92502-230800
	15	Inlet Valve Push Cover	2	70123-11150	1	70123-11150	2	70124-11150	1	70123-11150
	16	O-ring G-40(Inlet Valve)	2	93602-810040	1	93602-810040	2	93602-810055	1	93602-810055
	17	Viton O-ring G-40 (Outlet Valve)	2	93602-870040	1	93602-870040	2	93602-870055	1	93602-870040
	18	Unloading Piston	2	70123-11220	1	70123-11220	2	70124-11220	1	70123-11220
	19	O-ring P-20	2	93601-810020	1	93601-870020	2	93601-810021	1	93601-870020
	20	Outlet Valve Push Cover	2	70123-11450	1	70123-11450	2	70124-11450	1	70123-11450
	20A	Interstage Safety Valve (E71 only)	-	N/A	-	N/A	1	93132-15006-40101	-	N/A
Cylinders	21	Cylinder Head (1 st)	2	70123-11010			2	70124-11010		
	22	Cylinder & Head Gasket	2	70123-11612	1	70123-11612	2	70124-11612	1	70123-11612
	23	Cylinder (1 st)	2	70123-51012			2	70124-51011		
	23A	S/N A311xxxx & Later Use	2	70123-51012			2	70124-51011		
	24	Cylinder & Case Gasket	2	70123-51610	1	70123-51610	2	70124-51610	1	70124-51610
	25	Compression Ring (1 st)	4	70123-61030			4	70124-61030		
	26	Oil Control Ring (1 st)	4	70123-61050			4	70124-61050		
	27	Piston (1 st)	2	70123-61011			2	70124-61011-1		
	27A	S/N 3020000 & Later Use	2	70123-61011			2	70124-61011-1		
	28	Piston Snap Ring	4	70123-61070	2	70123-61070	4	70124-61070	2	70124-61070
	29	Piston Pin (1 st)	2	70123-61120			2	70124-61120		
	30	Conn'cting Rod Pist. Pin Bushing	2	70123-61081	1	70173-62080	2	70124-61080	1	70174-62081
	30A	Bushing S/N 3020000 & Later use	2	70123-61081						
	30B	Nedl Brg.S/N A303XXXX&LatrUse							1	93503-RNA6903R
	30C	Nedl Brg.(2 nd)/S/N A405XXXX&Latr			1	93503-TA1725				
	31	Connecting Rod Assy	2	70123-61200	1	70173-62200	2	70124-61201	1	70174-62202
	31B	Conn. Rod Assy., 2 nd Stage S/N A405XXXX & Later Use			1	70173-62200				
	32	Connecting Rod Crank Pin Metal	4	70123-61090	2	70123-61090	4	70124-61090	2	70124-61090
	33	Connecting Rod Bolt	4	70125-61250	2	70125-61250	4	70125-61250	2	70125-61250
	34	Oil Splash Dipper	2	70122-61282	1	70132-61290	2	70134-61281	1	70134-61290
	35	Oil Splash Dipper Bolt	2	91507-2304012	1	91507-2304012	2	91507-2304012	1	91507-2304012
	36	Cylinder Head (2 nd)			1	70123-11010			1	70174-12010
	37	Cylinder (2 nd)			1	70173-52010			1	70174-52011
	37A	Cyl (2 nd),S/N 3020000 & Later Use							1	70174-52011
	38	Compression Ring (2 nd)			3	70112-61030			3	70123-61030
	39	Oil Control Ring (2 nd)			1	70112-61050			2	70123-61050
	40	Piston (2 nd)			1	70173-62010-1			1	70174-62010-1
41	Piston Pin (2 nd)			1	70173-62120			1	70174-62120	
Crankcase & Crank Assembly	42	Crankshaft	1	70133-56011			1	70134-56010		
	43	Crankshaft		-			1	70134-56030		
	44	Counterweight Lock Washer		-			2	70124-56830		
	45	Counterweight Mtg. Bolt		-			2	70124-56810		
	46	Crankcase	1	70133-57010-4024			1	70134-57010-4024		
	47	Front Bearing Cover	1	70133-57030			1	70134-57030		
	48	Front Bearing Cover Gasket	1	70123-57950			1	70124-57950		
	49	Rear Bearing Cover	1	70133-57061			1	70134-57061		
	49A	Rear Brg Cvr, S/N 3020000 & Latr	1	70133-57061			1	70134-57061		
	50	Rear Brg Cvr Gasket	1	70133-57960			1	70134-57960		
	51	Front Bearing	1	93501-6306			1	93502-32210		
	52	Rear Bearing	1	93501-6306			1	93502-32210		
	53	Front Oil Seal	1	70123-57080			1	70134-57080		
	54	V-Pulley Pin	1	70123-56061			1	70134-56060		
	55A	Compressor Fan		-			1	70124-76310		
	55B	Compressor Pulley	1	70133-76010			1	70134-76011		
	56	Compressor Pulley Washer	1	92521-232000			1	70124-76210		
	57	Compressor Pulley Set Bolt	1	91501-1312030			1	91501-1312040		
	58	Gauge Cover	1	70111-57700			1	70124-57700		
	58*A	Oil Level Gauge Assy.	1	70704-57700				-		
	59	Gauge Cover Seal	1	70111-57730			1	70124-57730		
	59*A	Oil Level Gauge "O" Ring	1	93602-8126026				-		
	60	Crankcase Oil Cap	1	CCC1257			1	CCC1257		
	61	Crankcase Oil Plug	1	90112-100404			1	90112-100404		
	62	Breather Assembly	1	CCC1375			1	CCC1258		
	66A	Air Strainer Assembly	2	70123-66000			2	70123-66000		
	67	Air Strainer Filter	2	70123-66140			2	70123-66140		
	69	Outlet Pipe Joint B	1	70123-87020			1	70174-87020		
	70A	Comp.body.discharg.pipe.assy. 1 st	1	70133-87101 short			1	70134-87101 short		
	70B	Comp.body.discharg.pipe.assy. 1 st		-				-		
	70C	Comp.body.discharg.pipe.assy.2nd		-				-		
	70D	Comp.body.discharg.pipe.assy.2nd	1	70173-87300 long			1	70174-87300 long		
71	Outlet Pipe Joint A	2	70123-87010			3	70124-87010			
72	Outlet Pipe Joint D	1	70173-87010							
73	Outlet Pipe Joint C									
74	Gasket Manifold		-				-			

*E 50, START S/N AS4030343