

QuickStart Guide D-550 ZOOM

Need more help?

visit <http://support.olympusamerica.com> for 24/7 online automated help

OLYMPUS

Olympus America, Inc.
Two Corporate Center Drive
Melville, NY 11747-3157

It is strongly recommended that you follow these step-by-step numbered instructions to set up and quickly begin using your new D-550 Zoom Digital Camera.

START HERE

For more detailed instructions on advanced features, please refer to the printed Basic Manual included in your package, or the Reference Manual on the CD-ROM.

1 UNPACKING THE BOX CONTENTS

Gather your D-550 Zoom and all the parts as shown in the illustration. You'll need these items to complete the steps for the camera set up procedures that follow.

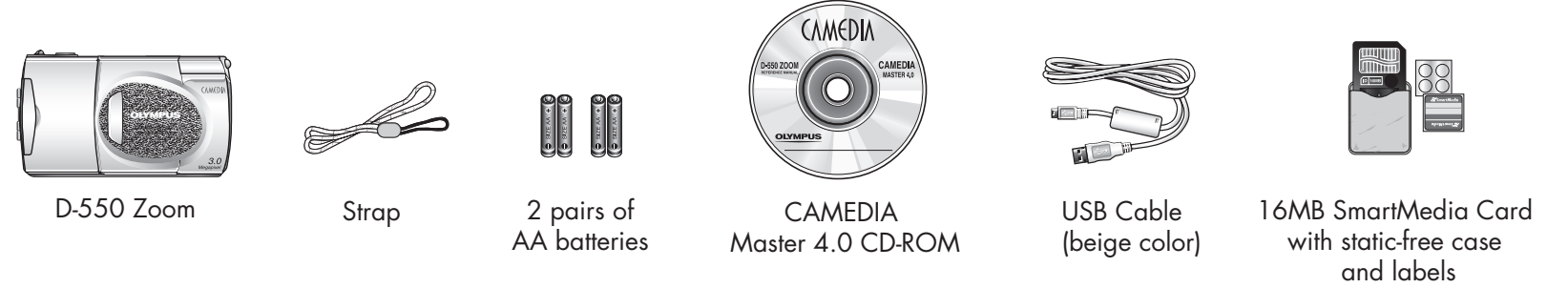

2 PREPARE THE CAMERA FOR USE

Before you begin using your Olympus D-550 Zoom Digital Camera...

a. Load the Batteries

Load **4 AA batteries** into the compartment as indicated in the illustrations and on the camera body. Close the cover and slide it towards the camera body until you feel a click. Put the battery compartment door back into the locked position.

Confirm you have installed the batteries properly and that there is power to the monitor by pressing **OK**. The "No Card" message should be displayed in the LCD monitor. Turn the monitor off by pressing **OK** again.

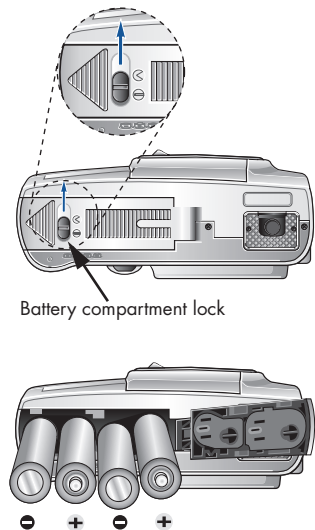

TIP: For best results, Olympus strongly recommends using four AA nickel metal hydride (NiMH) rechargeable batteries. An optional Olympus AC adapter also is available, and is recommended when downloading images to ensure a consistent power supply. See the D-550 Zoom Basic Manual for more information on battery use.

b. Insert the SmartMedia™ Card

The SmartMedia card is where the camera stores your pictures. The pictures you take remain on the SmartMedia card even when the camera is turned off and/or the batteries are removed.

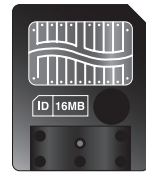

First make sure the sliding front cover is closed. Open the card cover door and note the diagram on the inside. Match the orientation of the SmartMedia card to the diagram, and slide the card into the slot as far as it will go. Close the cover until it locks into place; you will feel it snap closed.

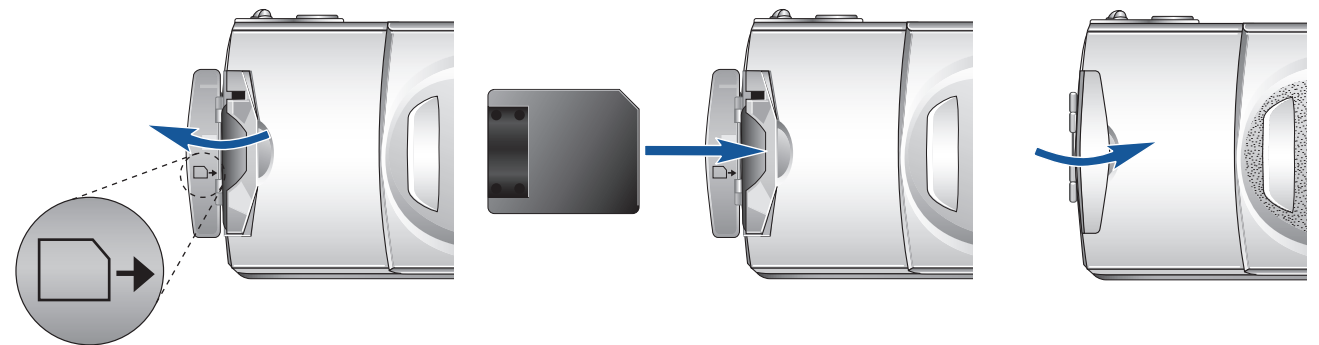

c. Attach the strap (OPTIONAL)

Attach the strap as illustrated to make the camera easier to handle.

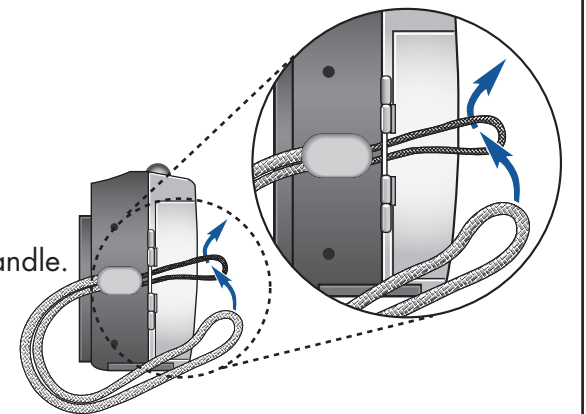

3 TURNING ON THE CAMERA

All you need to do is slide the lens cover open or closed to turn the camera ON or OFF.

a. Turn the camera ON (Shooting Mode)

Open the lens cover fully. You should feel **two clicks**. The lens barrel extends and the flash pops up.

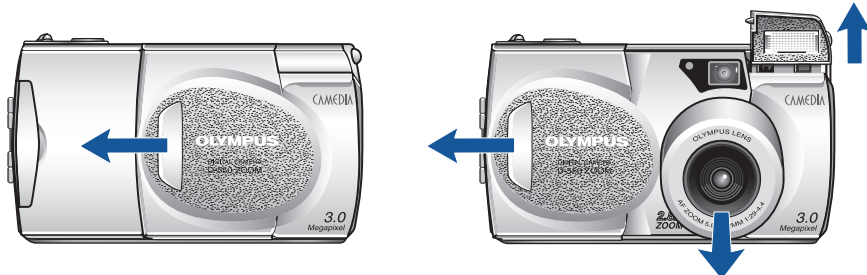

If the lens barrel does not extend, the lens cover is probably not fully open. Slide the lens cover completely to the open position.

To turn the camera off, slide the lens cover until you feel the first click. Allow the lens barrel to retract, then close the lens cover completely, and press the flash down until it locks into place.

TIP: To maximize battery life, the D-550 Zoom features a power saving mode in which the camera enters a sleep mode after approximately three (3) minutes of non-use. Press the shutter button or zoom lever to wake up the camera.

b. Set the Date and Time (OPTIONAL)

Although this is not required, it is recommended that you set the date and time. This affects the way image file names are created, and will conveniently stamp each picture with this information.

- Open the lens cover fully, then press **OK**.
- Press **MODE** to select MODE MENU.
- To get to the Date/Time menu setting, press **DOWN** three times to scroll to the SET tab.
- Press **OK**, and then **DOWN**. The **DATE** will be highlighted. Press **DOWN**.
- Use **LEFT** and **RIGHT** to select the desired date format (usually M, D, Y).
- Press **DOWN** to proceed to the next field. Adjust the date and time in the appropriate fields using **LEFT** and **RIGHT**. Repeat this step until all date/time fields have been set.

▶ **Note: Time is entered using the 24-hour format.**

- Press **OK** twice to set the date and time and exit the menu.

c. Camera Diagram and Controls

Now take a moment to familiarize yourself with the key areas of camera controls by reviewing the illustrations.

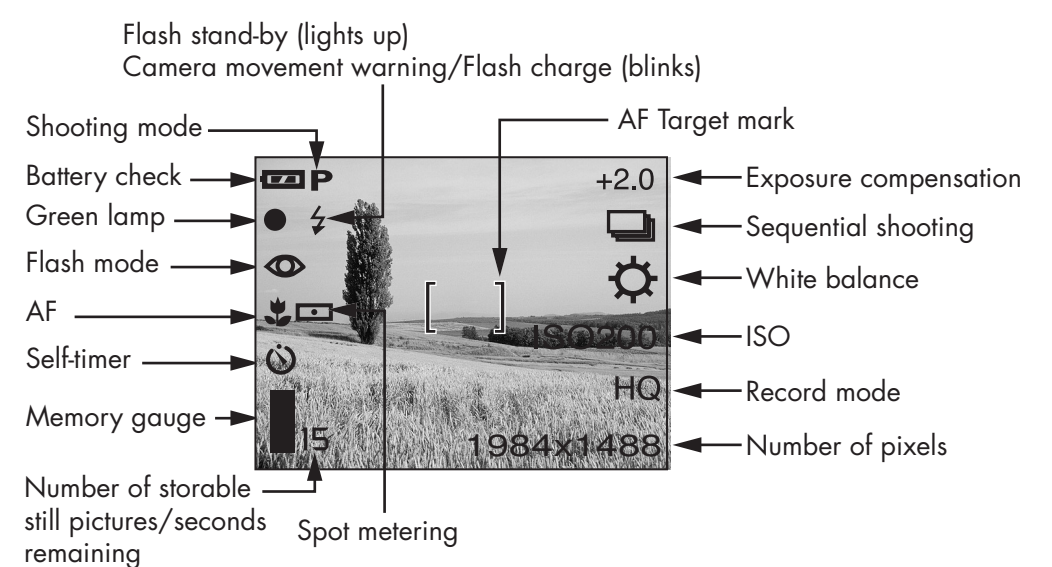
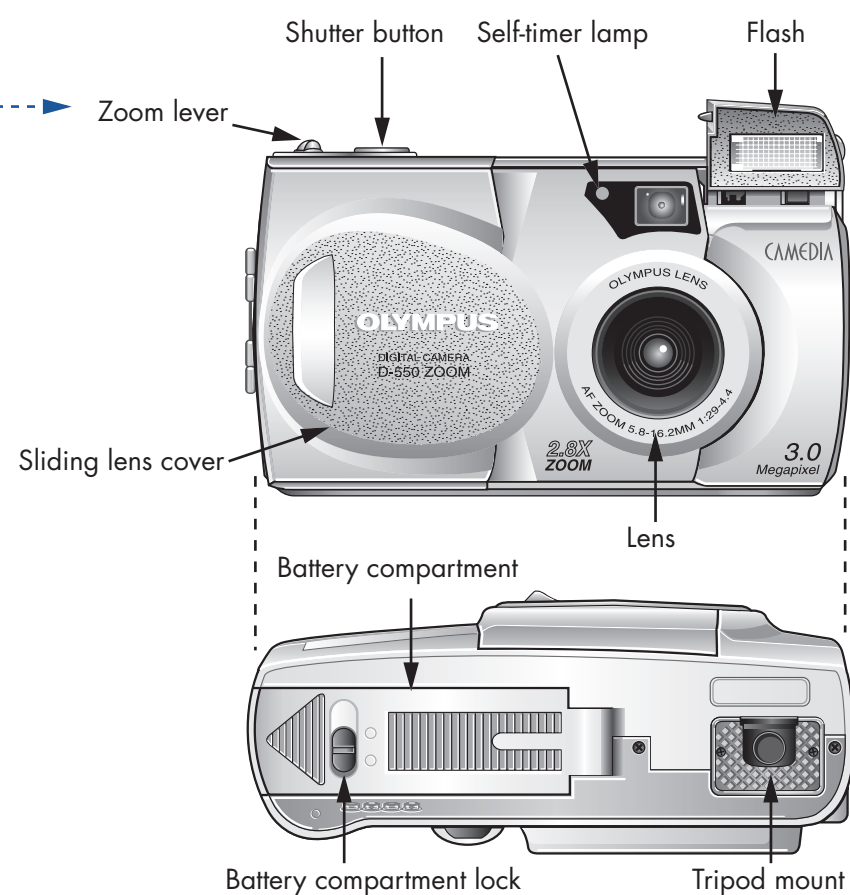
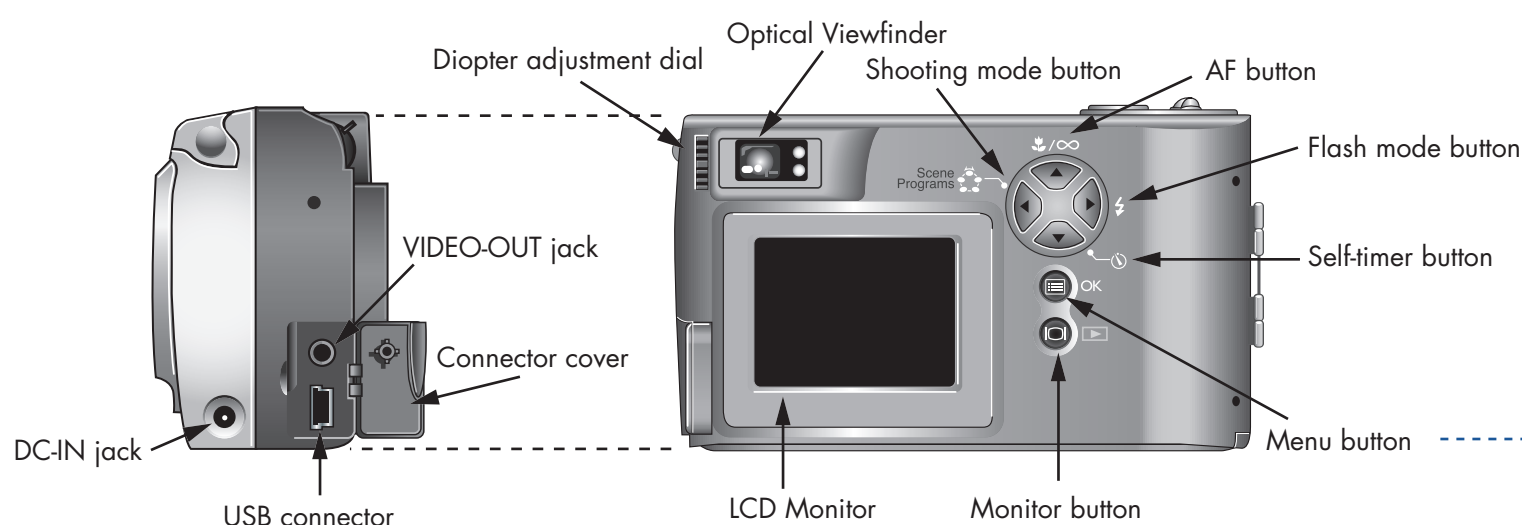

Camera Settings in Playback Mode as shown in LCD Monitor

▶ **Note: Depending on the camera settings, not all indicators will be displayed.**

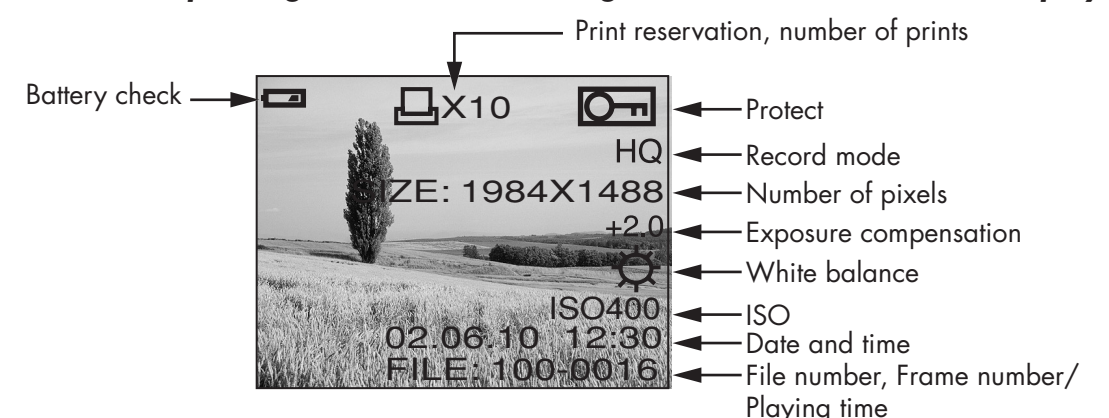

4 TAKING PICTURES

There are two ways to compose your subject - with the optical viewfinder or using the LCD monitor. Depending on the shooting situation, there may be advantages to each method. Please refer to the printed Basic Manual for more information.

a. Taking a Picture with the Optical Viewfinder

- Turn the camera on and frame your subject using the crosshairs in the optical viewfinder.
- Press the shutter button halfway.

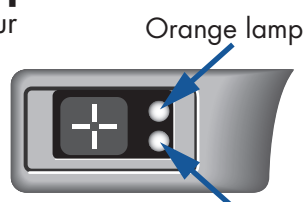

The D-550 Zoom confirms the focus and exposure are properly set when the green lamp in the viewfinder lights steady. The orange lamp informs you that the flash is recommended and/or recharging (when blinking); or ready to fire (when steady).

- Press the shutter button completely to take the picture. A short beep confirms your picture has been taken.

b. Taking a Picture with the LCD Monitor

- Press **Q** once while in shooting mode, and frame your subject using the full-color LCD monitor.



Icons representing camera settings appear on the LCD, telling you important information such as the Flash, Recording, and Image Quality modes, battery life, and the number of frames remaining.

- Press the shutter button down halfway.
- Press the shutter button completely to take the picture. A short beep confirms your picture has been taken.

c. Zooming

The D-550 Zoom features a zoom lens, allowing you to get closer to the action, or capture wide-angle shots and get everything into the picture.

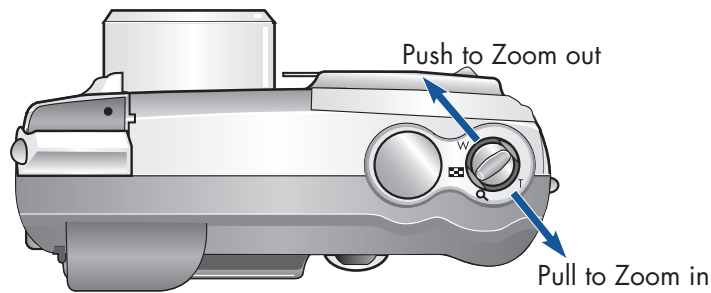

- Pull the lever toward "T" to choose telephoto shooting and get closer to your subject.
- Push it toward "W" to choose wide-angle shooting.

d. Flash Modes

While in shooting mode, press **Q** to cycle through and manually select one of the D-550's four flash modes:

Flash Icon	Flash Mode	Description
No icon	Auto-flash	The camera automatically decides if the flash is needed.
Eye icon	Red-eye Reduction	Reduces incidence of red-eye by emitting pre-flashes to shrink pupil size before firing the main flash. The strobe effect is normal operation for this mode.
Lightning bolt icon	Fill-in Flash	The flash always fires with every picture.
Lightning bolt with slash icon	Flash off	Turns the flash off for times when flash photography is prohibited or not desired. The flash never fires.

e. Number of Storable Pictures

Your D-550 Zoom Digital Camera package includes a 16 MB SmartMedia card. In the default quality setting of HQ mode (High Quality), you have enough capacity to store approximately 21 pictures.

This mode allows you to capture high quality images with medium file sizes. The HQ mode is suitable for most shooting situations.

See the D-550 Zoom Basic Manual for complete descriptions of each quality mode, and the storable frame capacity for the various resolution modes and SmartMedia card capacities.

TIP: To find out how many frames you have left, turn on the LCD monitor and look for the number in the lower left corner. Remember, you can always delete unwanted pictures to make room for more. (See Step #5).

5 VIEWING AND ERASING PICTURES

With the D-550 Zoom, you can easily view photos and delete the ones you don't want.

a. Viewing Pictures

There are two ways to access the Playback mode:

- If the camera is OFF and the lens cover closed, press **Q** once.
- OR**
- If the camera is in the shooting mode with the lens cover fully open and lens barrel extended, press **Q** twice in rapid succession (Quick View).

The last picture taken appears in the LCD monitor. Use **Q** to scroll through the images saved on the SmartMedia card.

When you are finished reviewing your pictures:

- Press **Q** to turn the camera off.
- OR**
- To return to the shooting mode, press **Q** once again, or press the shutter button halfway.

b. Erasing Pictures

The beauty of digital photography is your ability to keep the photos you want, delete the rest, and reuse empty memory space to take new pictures. The D-550 Zoom offers two ways to permanently erase unwanted digital photos:

Single-Frame Erase: Deletes only the picture currently displayed in the LCD monitor.

Once erased, pictures cannot be restored.

- With the lens cover closed, press **Q** and use the arrow keys to display the picture you want to erase.
- Press **OK**, then press **Q** to select ERASE.
- Use **Q** to highlight YES, and press **OK**. The picture is now erased.

TIP: Images can also be erased while in the Quick View mode described in Step 5a. This makes it easy to quickly erase a picture that you just took.

All-Frame Erase: Deletes all pictures on the SmartMedia card in one operation, except for pictures you have protected.

Once erased, pictures cannot be restored.

- With the lens cover closed, press **Q**.
- Press **OK**, then press **Q** to select MODE MENU.
- Use **Q** to select the CARD tab, then press **Q** twice to access the CARD SETUP screen.
- Use **Q** to highlight ALL ERASE, and press **OK**.
- As a safeguard, the D-550 Zoom will ask you to select YES or NO to confirm erasing, as this process permanently deletes all unprotected pictures. Select YES and press **OK**.

6 CONNECTING THE CAMERA TO A COMPUTER

TIP: Olympus recommends the use of an optional AC adapter to ensure a consistent power supply when downloading images.

Make sure that the camera is turned off before connecting it to your computer.

Olympus makes it simple to connect the D-550 Zoom to your computer.

- Turn the camera off.
- Plug the supplied USB cable into the ports on your camera and computer as illustrated.

Windows 98 users must install the "USB Driver for Windows 98" software before connecting the D-550 Zoom to the computer. Refer to the Software Installation Guide for complete information.

- Put the camera into the computer communications mode by turning it on. Open the front cover, or press **Q**.

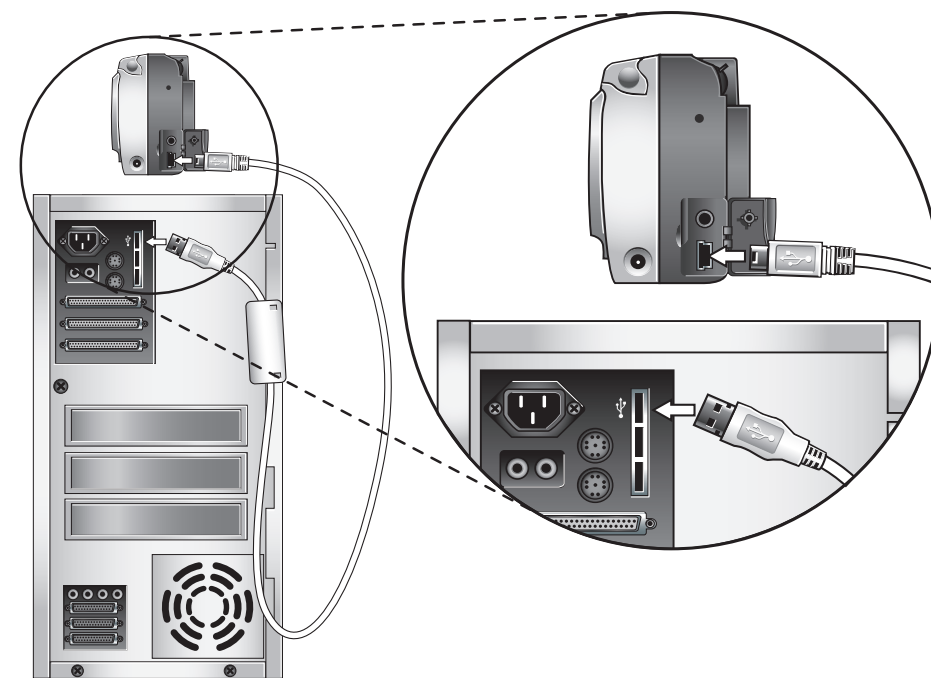

7 INSTALLING THE CAMERA SOFTWARE

You've now mastered the basic functionality of your new Olympus D-550 Zoom Digital Camera! You are now ready to begin exploring the possibilities that digital photography brings to your computer. Activities such as photo editing, e-mailing, printing, and much more are only steps away!



About the Olympus CAMELIA Master 4.0 CD-ROM

Your Olympus D-550 Zoom Digital Camera comes bundled with a suite of software and documentation. The CD includes:

- **CAMELIA Master 4.0:** To download pictures from the camera and view, organize, retouch, share, and print your digital photos and movies.
- **USB Driver for Windows 98:** This utility must be installed to allow the camera to communicate with your computer if it uses the Microsoft Windows 98 operating system.
- **Adobe Acrobat Reader 4.0:** To access the D-550 Zoom Reference Manual stored on the CD-ROM in PDF format.
- **Olympus D-550 Zoom Reference Manual:** A complete reference guide in digital form, saved on the CD in PDF format.

You may or may not need to install all of these applications, depending upon your type of computer and whether you have previously installed some titles.

You are now ready to install the computer software.

- Open the **CAMELIA Master 4.0 CD-ROM** package and locate the **Software Installation Guide** in the language you wish to use.
- Continue to follow the step-by-step instructions for installing the software, and enjoy your new digital photo processing capabilities!

Additional Camera Features

The D-550 Zoom offers a host of advanced features to expand your creativity. Here's just a small sampling. See the D-550 Zoom Basic Manual for details on these capabilities, and more!

- **Diopter Adjustment:** This feature allows you to adjust the clarity of the viewfinder to match your eyesight.
- **Digital Zoom:** Allows you to extend the optical zoom range of the camera to get even closer to the action.
- **Macro Mode:** For extremely tight close-ups, select the D-550's Macro Mode.
- **Movie Mode:** Yes, the D-550 Zoom records movies! (Movie Mode does not record sound.)
- **7 Scene Program Shooting Modes:** Select the best camera setting that most closely matches your shooting situation with one touch.
- **Video Monitoring:** View your pictures and movies directly on a TV.
- **Printing Pictures:** You can make photographic prints using your computer and printer, or by using an Olympus P-400 or P-200 Photo Printer.
- **Close-up Playback:** The picture currently displayed in the LCD monitor may be enlarged several times, enabling you to check the details of any image.
- **Index Display:** You can view several thumbnail pictures on the LCD monitor at once.
- **Protecting Pictures:** Prevents you from accidentally erasing pictures.

TIP: Remember to complete and return your Registration Card, and keep all camera documentation handy.

For additional help, call 1-888-553-4448 8:00am - 10:00pm Eastern Time (Mon - Fri)