

MasterSheet

035 0020
Revision 08/18/15



Complete Car Audio
Installation Instructions

CRUTCHFIELD

IMPORTANT

Before starting, compare items on your invoice with items received. Carefully check through packaging material. If any item is missing, please call **Crutchfield Technical Support at 1-800-955-9094**.

Although reasonable attempts are made to verify the accuracy of the information contained in this MasterSheet, it is presented without warranties or guarantees of any type due to the constantly changing nature of this type of information and running changes in vehicle production. Any person or entity using this information does so at his or its own risk. If you find our instructions are different from your vehicle, or if you have questions, do not continue with your installation. Contact our toll-free technical support for assistance.

Inside...



0000350020

1996-'03
Mercedes
E Class (Sedan)
1998-'03
E Class (Wagon)



Page

2	Factory Radio Removal						✓		
3	Receiver Installation		✓					✓	
4	Dash Speakers	✓			✓				
5-6	Front Door Speakers	✓	✓		✓	✓	✓		
7-8	Rear Door Speakers	✓	✓		✓	✓			
9-11	Rear Deck Subwoofers	✓	✓	✓	✓	✓			
12	Wire Splicing Guide								✓

Tools Required ▶

Phillips Screwdriver	Small Flat Blade Screwdriver	10mm Socket, Ratchet & Extension	Panel Tool	T20 Torx Driver	Radio Removal Tools	Hack Saw Blade	Wire Strippers & Crimp Caps

CRUTCHFIELD
Copyright 2015 Crutchfield Corporation

If you need additional wiring information, visit us online at www.crutchfield.com/support/faq.html

Note: At this time, no aftermarket antenna is available from Crutchfield. A replacement antenna may be purchased from a local dealership.

035 0020

Factory Radio Removal

1. Before proceeding, eject cassette or CD from factory unit if present.
2. Set parking brake and disconnect negative battery cable to prevent any electrical short.
3. Insert radio removal tools into slots in face of factory radio until a click is heard from each location (Figure 1).
4. Pull out radio, disconnect and remove (Figure 2).

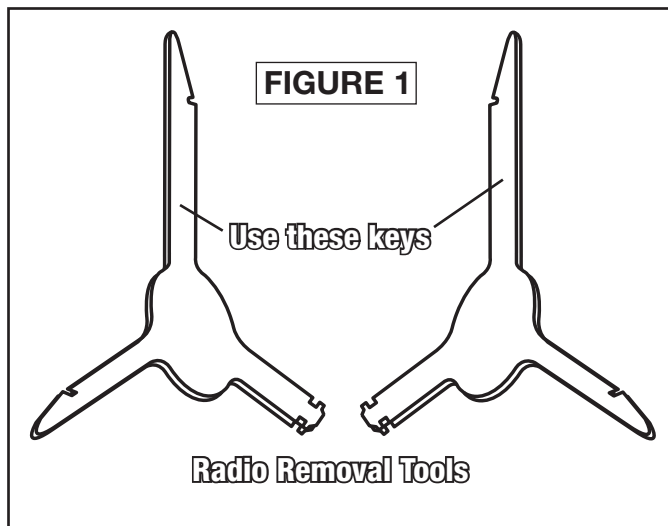

035 0020

Receiver Installation



IMPORTANT

These instructions apply to vehicles from 1996-2003 without navigation and 1996-2000 vehicles with navigation. A mounting bracket must be fabricated for 2001-'03 vehicles with navigation.

- 1. Receiver Wiring:** Modification to the factory radio harness may be required in order for the harness to work with the receiver wiring adaptor. Check the wiring harness in your vehicle with the receiver wiring adaptor received from Crutchfield. If necessary in order to make connection, use a hack saw to cut the body of the factory harness in half as shown (Figure 1). Follow instructions supplied with the receiver wiring adaptor to make wiring connections.
- 2. Remove DIN sleeve** from receiver (Figure 2).
- 3. Slide DIN sleeve** into dash opening and secure to dash by bending the securing tabs (Figure 3).
- 4. Hold receiver** near dash. Connect receiver wiring adaptor to vehicle harness. Using antenna adaptor, plug antenna lead into rear of receiver.
- 5. Slide receiver** fully into sleeve and test operation.

NOTES:

Please read first

- Check to make sure the Crutchfield receiver wiring adaptor plugs into the vehicle receiver harness. If the Crutchfield adaptor is incorrect, please call our **Technical Support Department at 1-800-955-9094.**

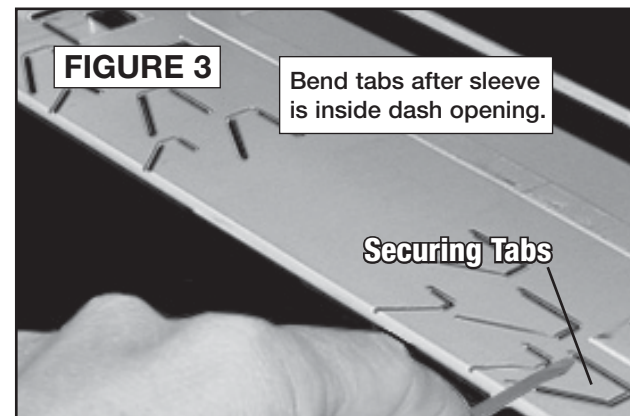
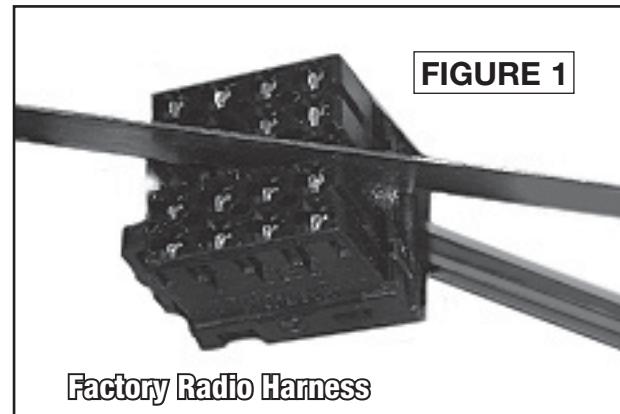

CAUTION:

Always be careful when cutting in a vehicle. **WEAR EYE PROTECTION.** Be aware of things such as wiring, windows, fuel lines and safety devices. Check cutting depth and location to avoid damage to vehicle appearance.



1-800-955-9094
TECHNICAL SUPPORT

CRUTCHFIELD®

Copyright 2015 Crutchfield Corporation

035 0020

Dash Speakers

NOTES:

Please read first

- Instructions show factory size speakers or speakers with adaptor brackets only. Cutting or fabrication (not shown) will be required for other speaker sizes.



IMPORTANT

No speaker wiring adaptor is available at this time from Crutchfield for this speaker location. It will be necessary to splice wires in order to install an aftermarket speaker.

No speaker adaptor bracket is available at this time for this location. A mounting bracket must be fabricated in order to install an aftermarket speaker.

It is possible that the replacement speakers do not have screws supplied. It may be necessary to acquire mounting hardware.

1. Pry off dash side cover. Remove one (1) exposed phillips screw (Figure 1).
2. Lift rear edge of speaker grille and pull toward rear of vehicle to remove (Figure 2).
3. Pry out speaker, disconnect and remove (Figure 3).
4. Fabricate a speaker mounting bracket and secure speaker to bracket.
5. Make wiring connections following instructions on page 12. Return to this page to complete installation.
6. Secure speaker/bracket assembly to location.
7. Test speaker operation and reassemble dash by reversing disassembly steps.

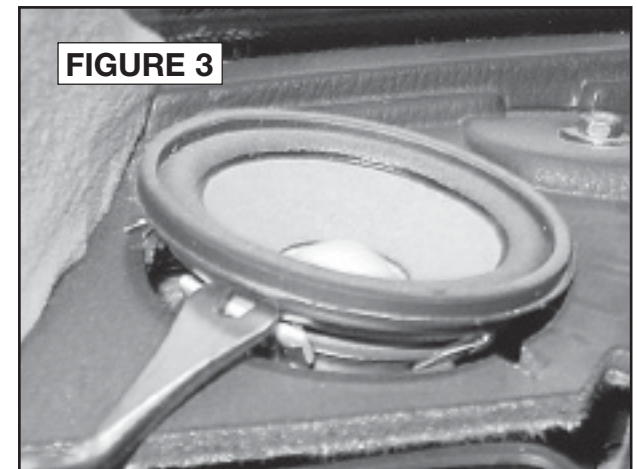
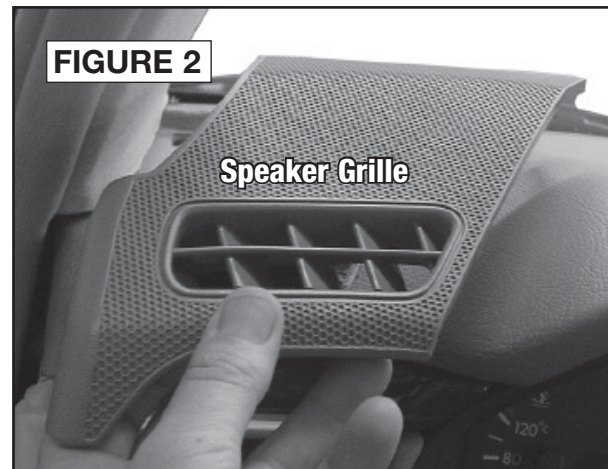
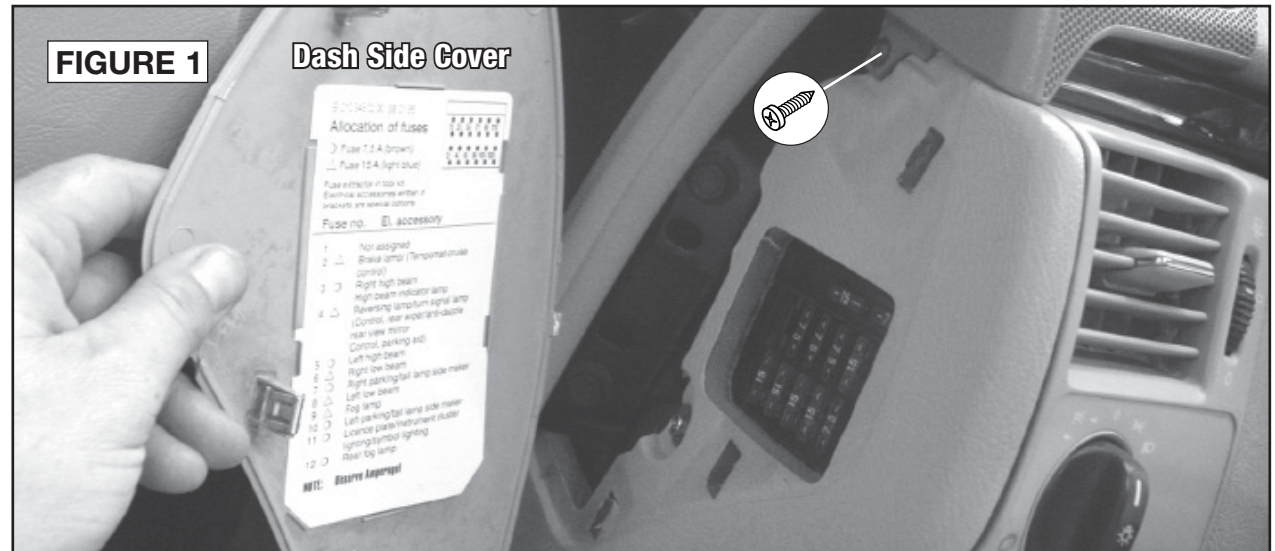

 1-800-955-9094
TECHNICAL SUPPORT

CRUTCHFIELD
Copyright 2015 Crutchfield Corporation 4

035 0020

Front Door Speakers

NOTES:

Please read first

- Instructions show factory size speakers or speakers with adaptor brackets only. Cutting or fabrication (not shown) will be required for other speaker sizes.

1. Pry off door release trim and remove one (1) exposed phillips screw (Figures 1 & 2).
2. Pry loose airbag emblem (screw cover). Remove one (1) exposed phillips screw (Figure 3).
3. Remove one (1) phillips screw from door latch trim and remove trim (Figure 4).
4. Unscrew door lock knob to remove (Figure 5).
5. Pry off screw cover located below door pull handle and remove one (1) exposed phillips screw (Figure 6).

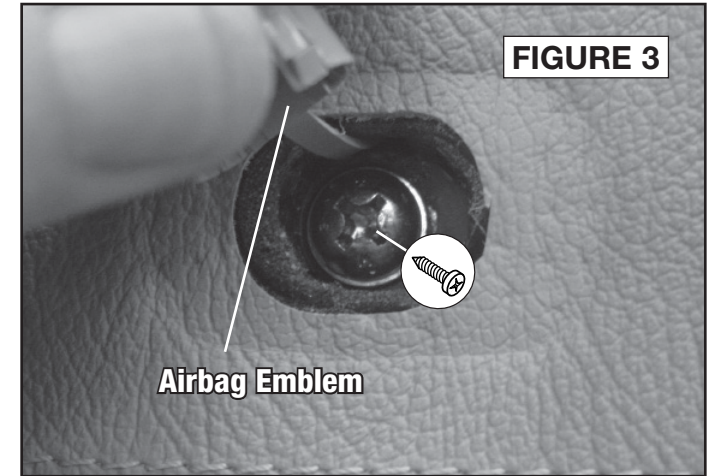
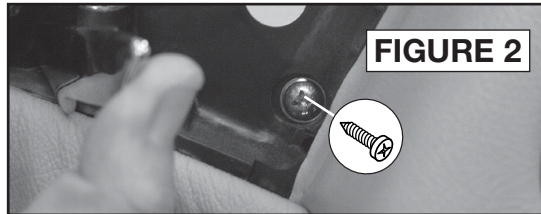

Continued on the next page.

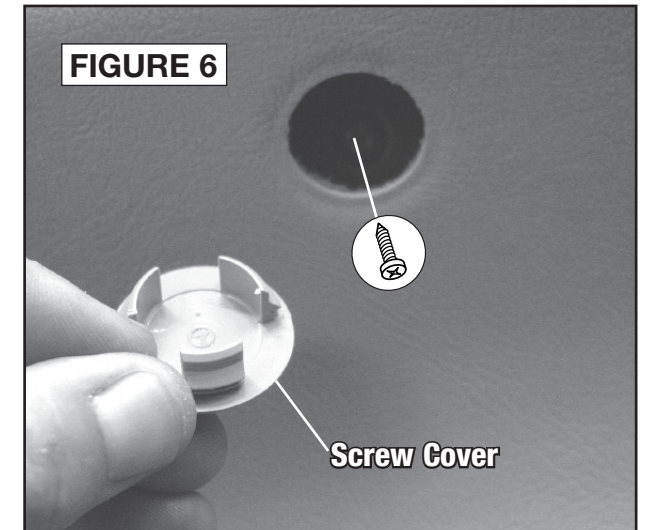
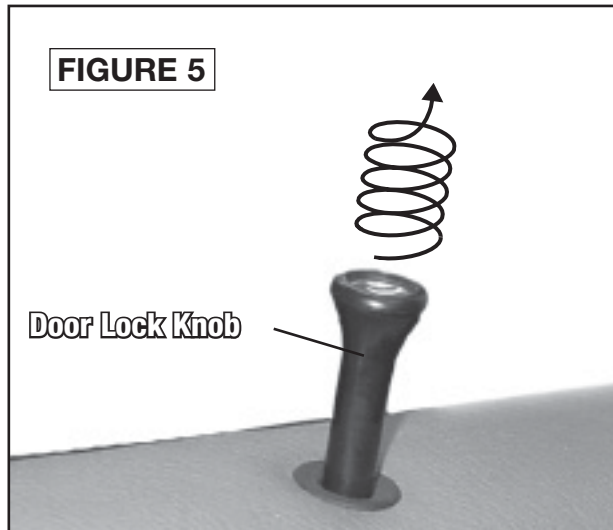
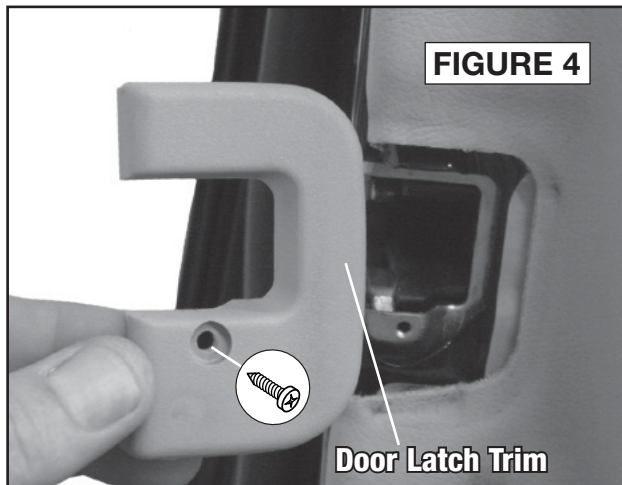

035 0020

Front Door Speakers (continued)

6. Pry around all sides of door panel to release nine (9) retaining clips. Disconnect door release cable and wiring harnesses and remove door panel (Figure 7).
7. Remove four (4) Torx T20 screws securing speaker. Pull out speaker, disconnect and remove (Figure 8).
8. Connect speaker wiring (factory spade connectors) to new speaker.
9. Secure new speaker with screws previously removed.
10. Test speaker operation and reinstall door panel by reversing removal steps.

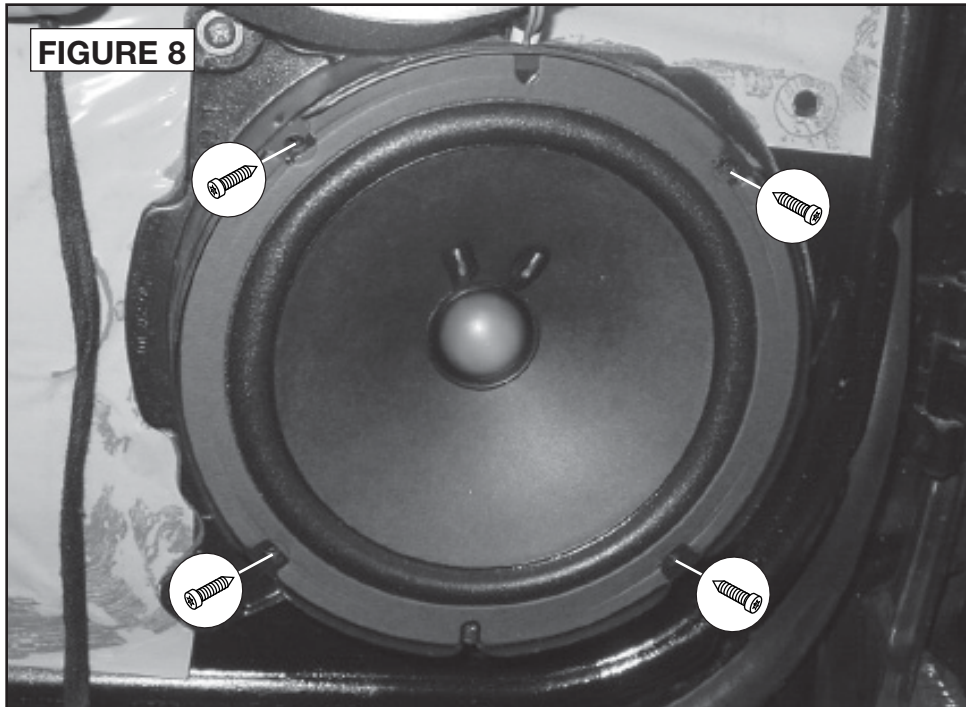

SAFETY CHECK

- Check that wires do not interfere with window operation.
- Test door lock and release operation.



1-800-955-9094
TECHNICAL SUPPORT

CRUTCHFIELD[®]
Copyright 2015 Crutchfield Corporation 6

035 0020

Rear Door Speakers

NOTES:

Please read first

- Instructions show factory size speakers or speakers with adaptor brackets only. Cutting or fabrication (not shown) will be required for other speaker sizes.

1. Pry off door release trim and remove one (1) exposed phillips screw (Figure 1).
2. Pry loose airbag emblem (screw cover). Remove one (1) exposed phillips screw (Figure 2).
3. Remove one (1) phillips screw from door latch trim and remove trim (Figure 3).
4. Unscrew door lock knob to remove (Figure 4).
5. Pry off screw cover located below door pull handle and remove one (1) exposed phillips screw (Figure 5).

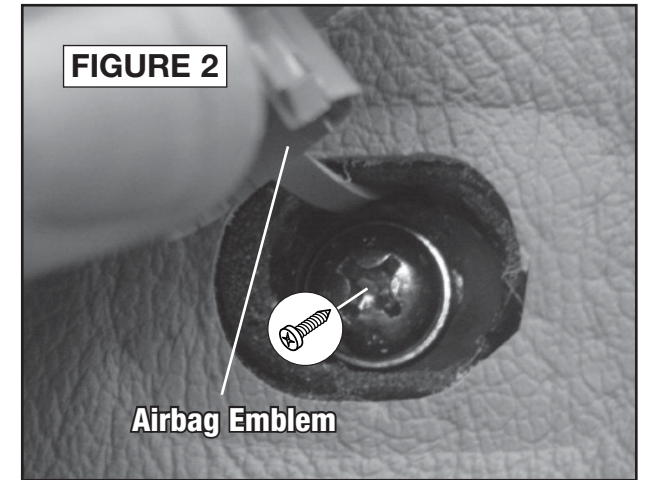
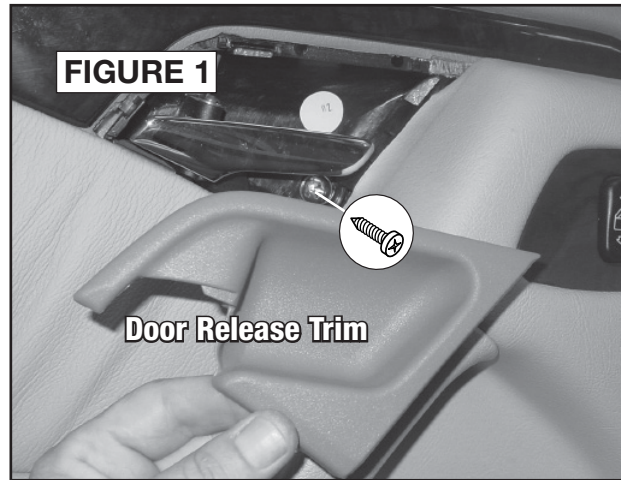

Continued on the next page.

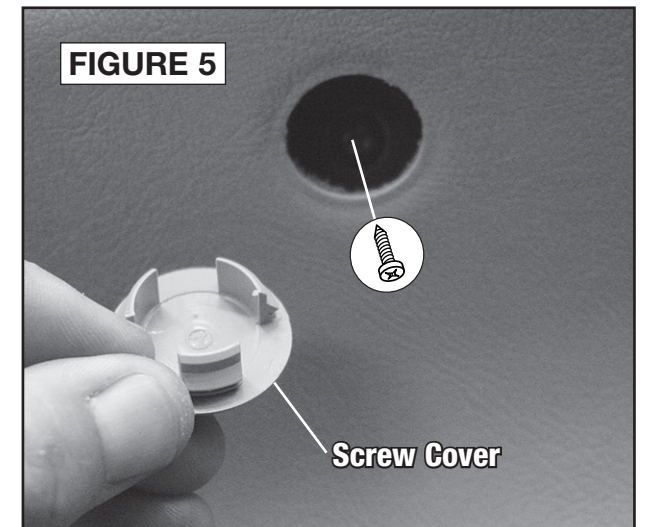
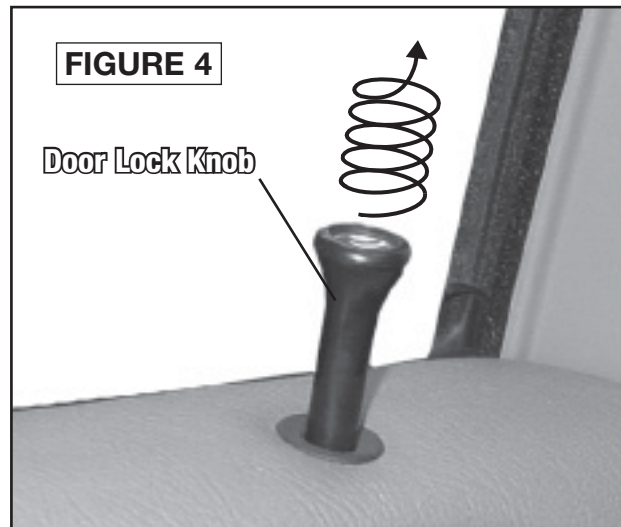
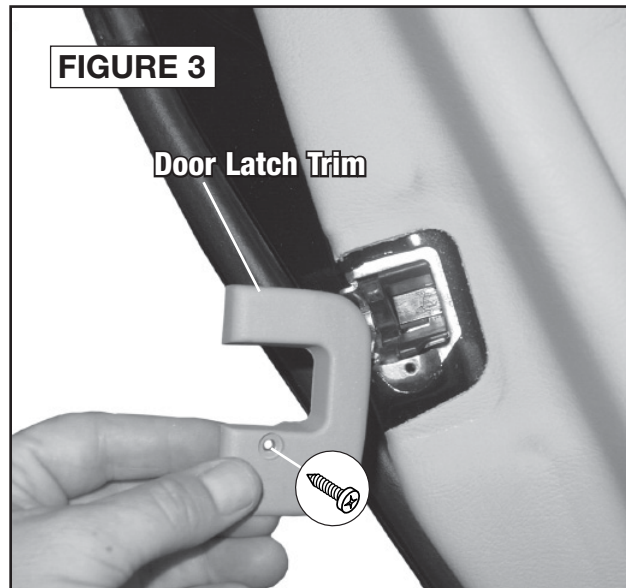

 1-800-955-9094
TECHNICAL SUPPORT

CRUTCHFIELD[®]
Copyright 2015 Crutchfield Corporation 7

035 0020

Rear Door Speakers (continued)

6. Pry out courtesy light at bottom of door panel. Disconnect wiring harness to remove (Figure 6).
7. Pry around all sides of door panel to release six (6) retaining clips. Disconnect door release cable and wiring harnesses and remove door panel (Figure 7).
8. Remove four (4) Torx T20 screws securing speaker. Pull out speaker, disconnect and remove (Figure 8).
9. Connect speaker wiring (factory spade connectors) to new speaker.
10. Secure new speaker with screws previously removed.
11. Test speaker operation and reinstall door panel by reversing removal steps.

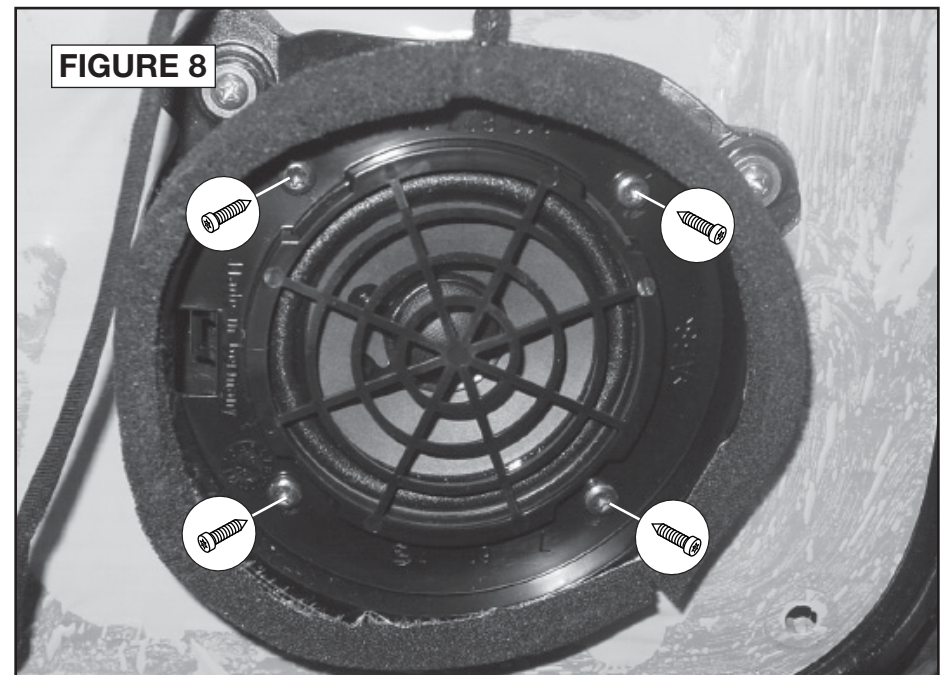
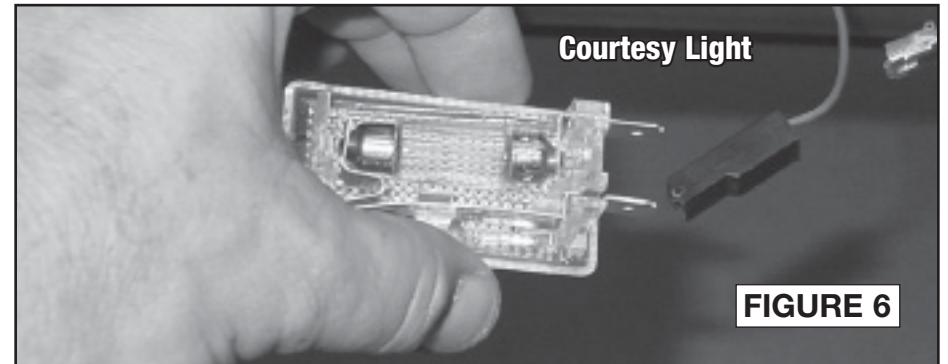

SAFETY CHECK

- Check that wires do not interfere with window operation.
- Test door lock and release operation.

035 0020

Rear Deck Subwoofers

NOTES:

Please read first

- Instructions show factory size speakers or speakers with adaptor brackets only. Cutting or fabrication (not shown) will be required for other speaker sizes.

1. Release two (2) clips (one under each end of seat bottom). Lift seat bottom to remove (Figure 1).
2. Remove three (3) 10mm bolts securing seat back (Figures 2 through 4). Lift and remove seat back.
3. Remove floor liner in trunk (Figure 5).
4. Bend two (2) metal tabs downward to release top of gas tank cover (Figure 6).
5. Remove two (2) Torx T20 screws from cover (one at each corner) (Figure 7).

Continued on the next page.

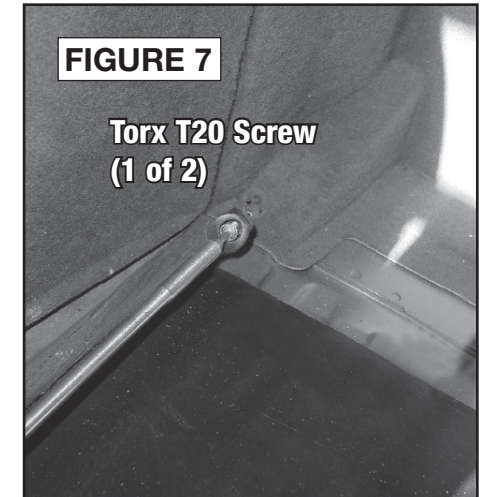
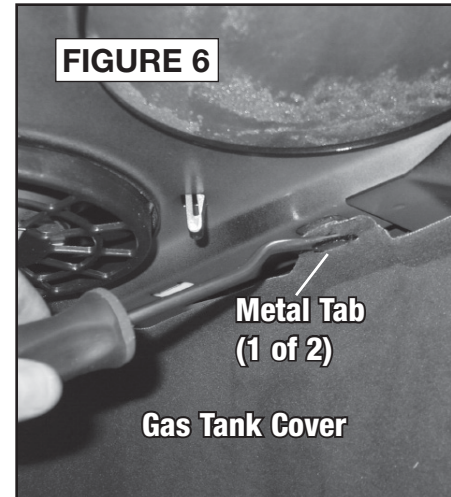
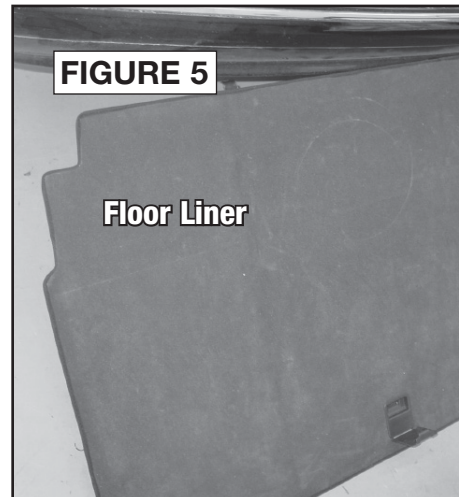
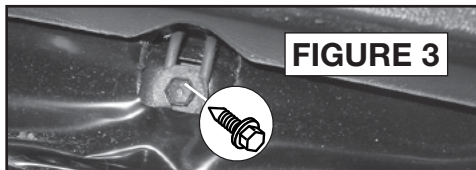
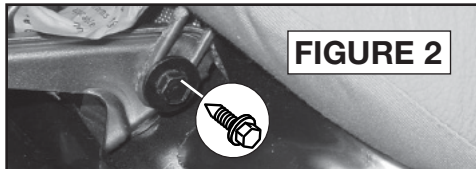
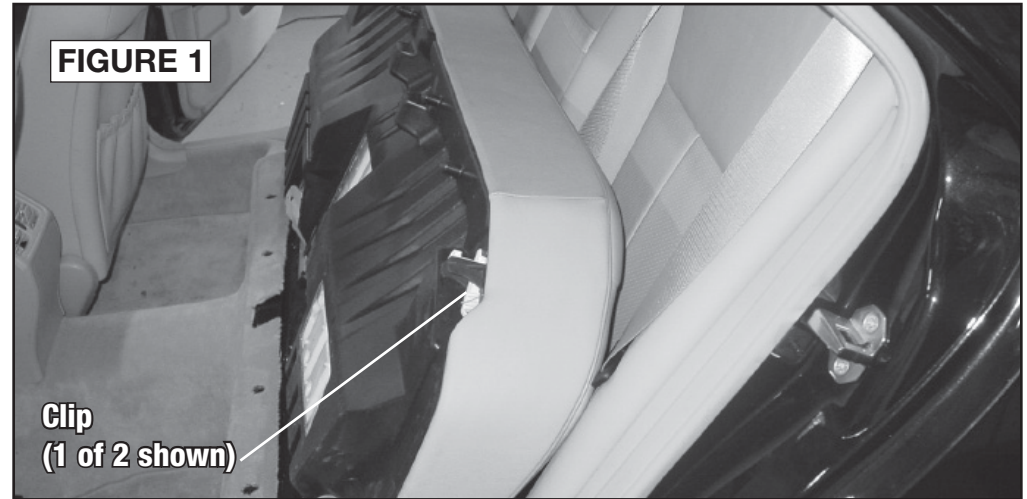

 1-800-955-9094
TECHNICAL SUPPORT

CRUTCHFIELD

Copyright 2015 Crutchfield Corporation 9

Rear Deck Subwoofers (continued)

6. Pry up retaining clips in bottom of cover by prying out center pins, then prying out clips (Figure 8).
7. Work gas tank cover loose and remove from trunk (Figure 9).
8. Lift headrests and pry off trim covers (Figure 10).
9. Push headrests straight toward rear of vehicle.
Note: Considerable force will be required. Remove headrest.
10. Pry off both rear pillar trimpanels and allow to hang (Figure 11).

Continued on the next page.

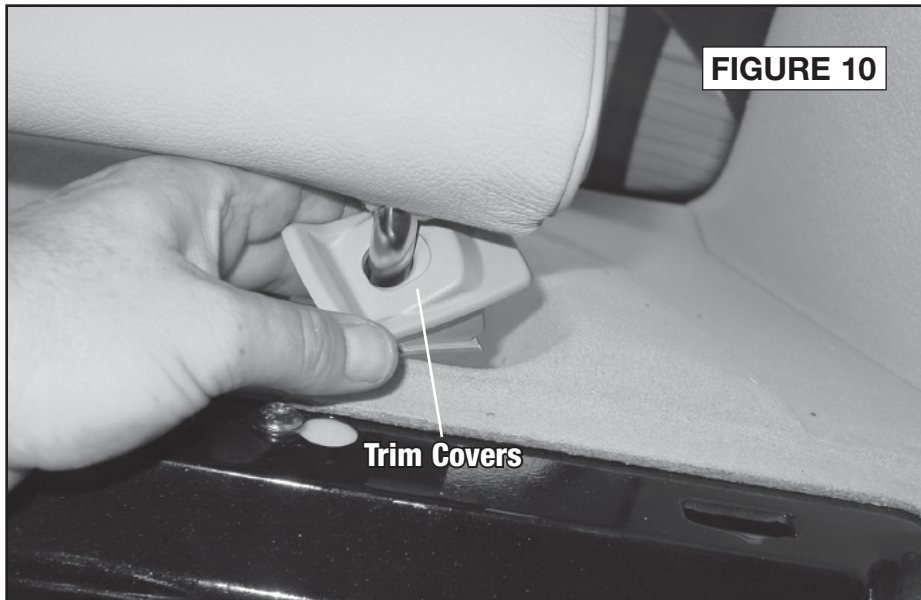
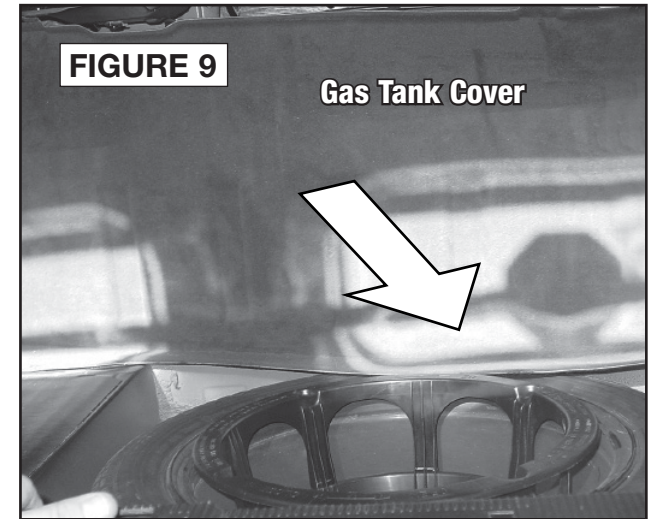
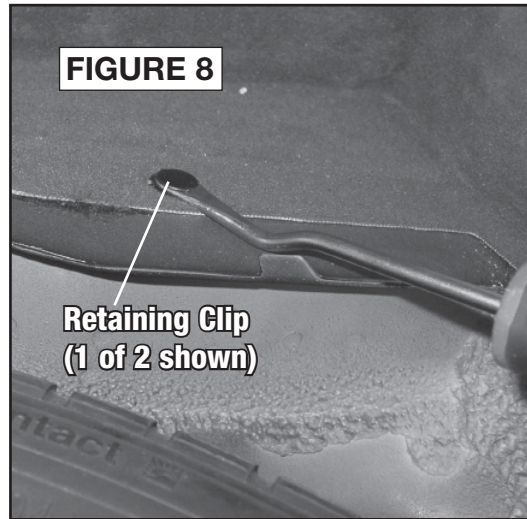

Rear Deck Subwoofers (continued)

11. Pry out two (2) retaining clips (one at each end) from rear deck panel by prying up center pins, then prying out clip (Figure 12). Lift panel enough to clear child seat anchors.
12. Pull panel toward front of car enough to access brake light wiring harness. Disconnect harness and remove panel (Figure 13).
13. Remove three (3) Torx T20 screws securing speaker. Pull out speaker, disconnect and remove (Figure 14).
14. Connect speaker wiring (factory spade connectors) to new speaker. Secure new speaker with screws previously removed.
15. Test speaker operation and reassemble rear of vehicle by reversing disassembly steps.

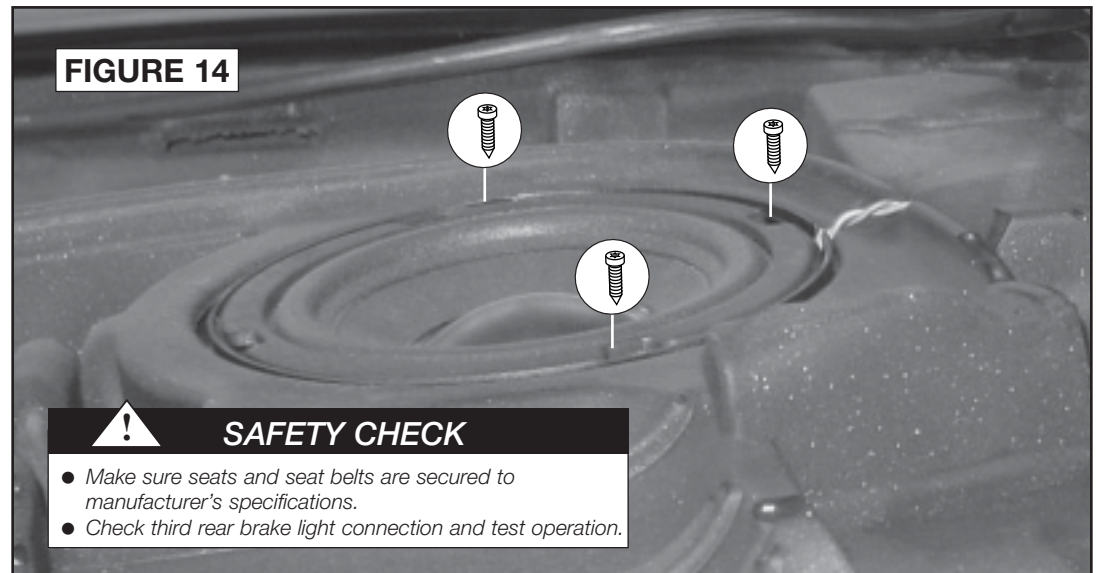
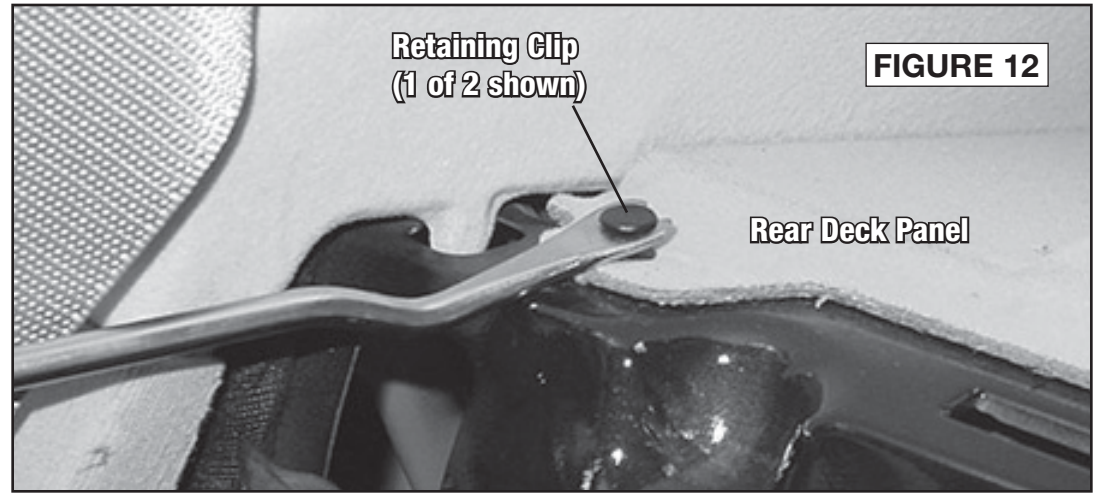

Wire Splicing Guide

These methods can be used to make wiring connections if no receiver or speaker wiring adaptor is available.

CRIMP METHOD

Factory harness is removed. Save harness if it is to be reconnected in the future by this method.

1. Cut factory wires behind factory speaker harness.

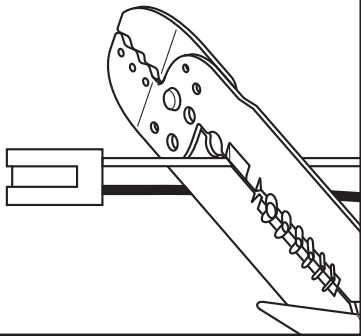

2. Strip end of each wire back 1/2".

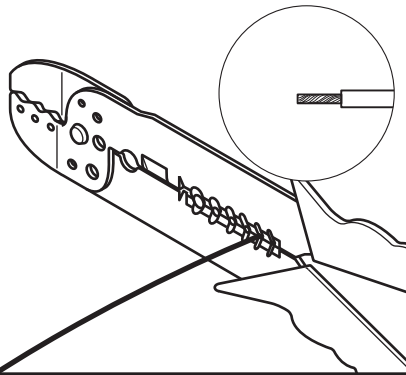

3. Twist each positive pair of wires together and insert in crimp cap. Repeat step for negative wires.

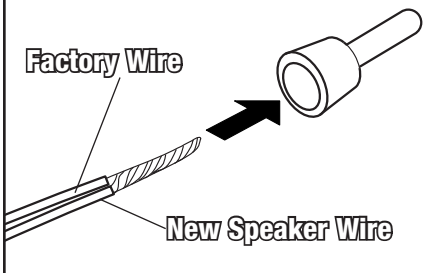

4. Squeeze middle of cap for tight connection.
5. Connect new wires to speaker with spade connectors.

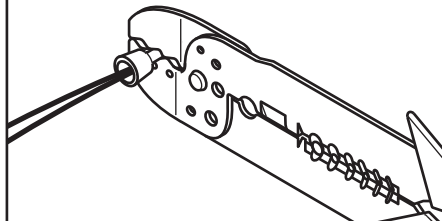

SOLDER METHOD

New speaker wires are spliced into factory wires behind harness.

1. Carefully strip out a 1/2" section on each factory speaker wire behind the factory speaker harness.

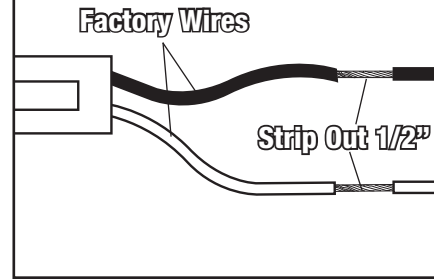

2. Twist wires from new speaker to stripped sections of factory wires as shown making sure polarity is correct.

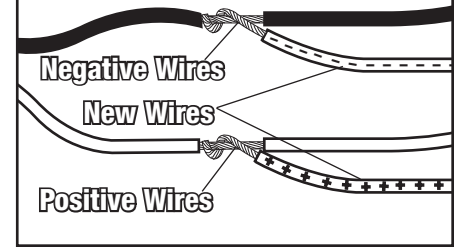

3. Heat wires first with soldering iron, then touch solder to wires for solid connections.

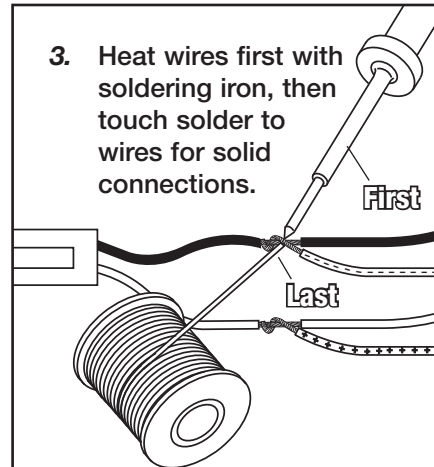

4. Wrap wiring connections with electrical tape.
5. Connect new wires to speaker with spade connectors.

